

SCM06

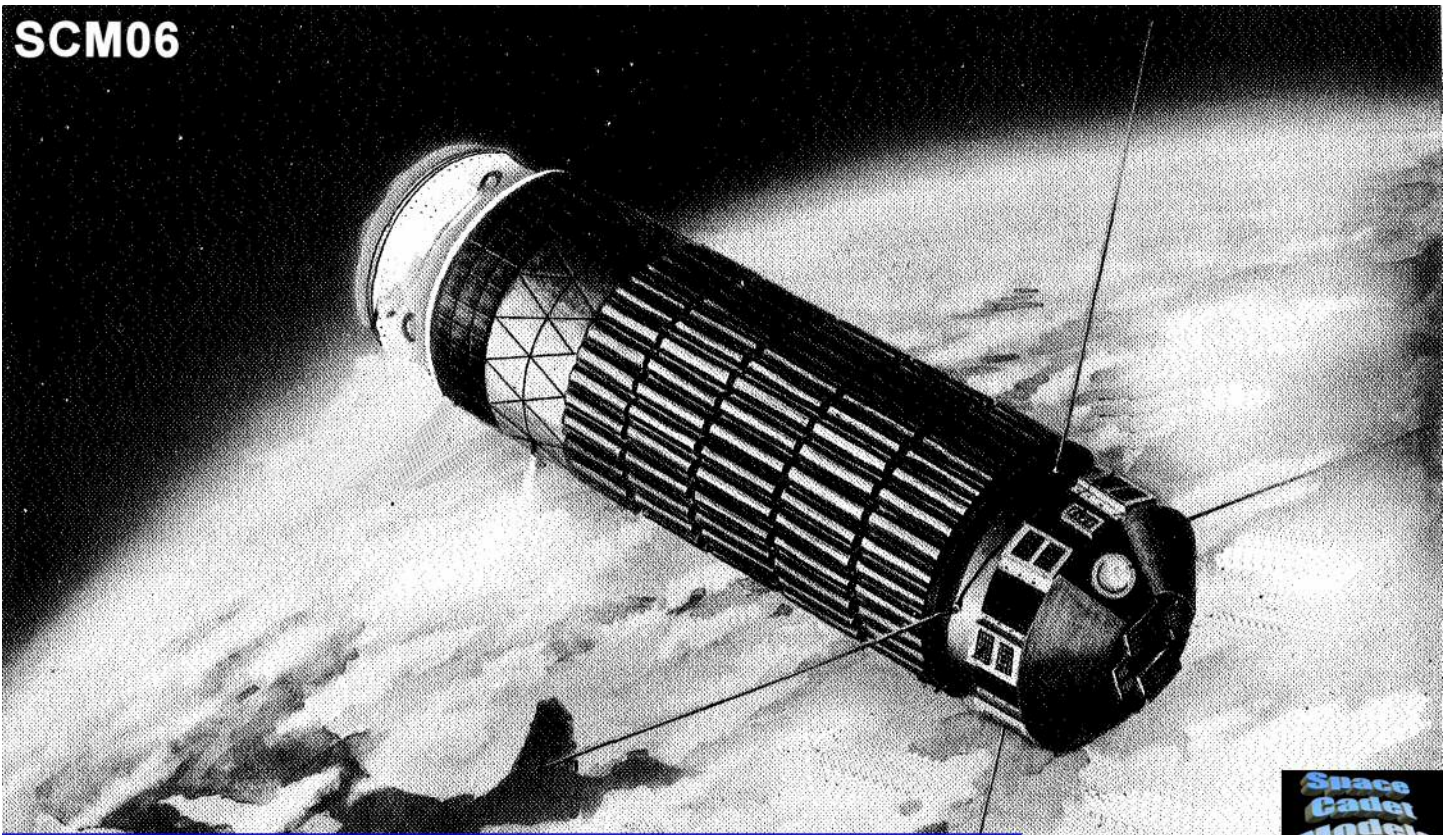

The Early Pioneers

Explorer 16

Assembly Instructions

by

Space Cadet Models

1/12th Scale

Thank you for your interest and purchase of our sixth kit. We have attempted to make the most detailed model that the scale size can support. We hope it will be a fun build for you.

EXPLORER 16 PAINTING INSTRUCTIONS

Use the following colors of paint to complete your model as indicated by the color icons listed below and as shown in Figures #1 and #2.



Black Paint



Silver Paint



White Paint



Light Gray Paint

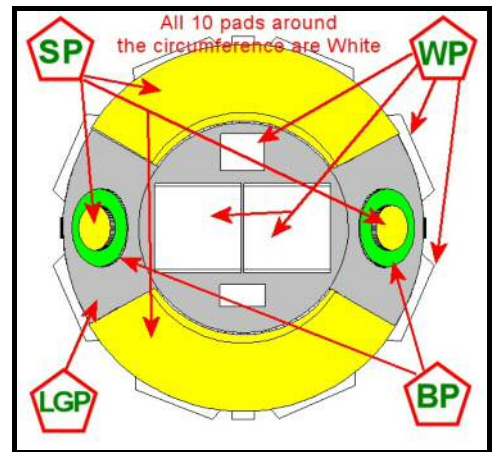

Figure 1

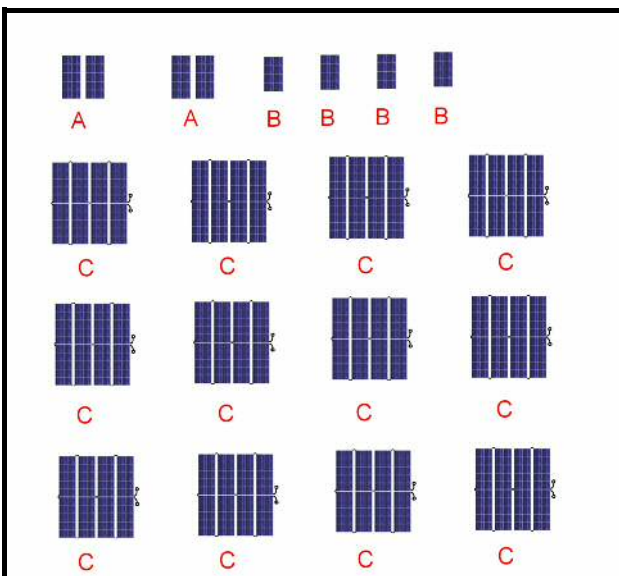

Figure 3

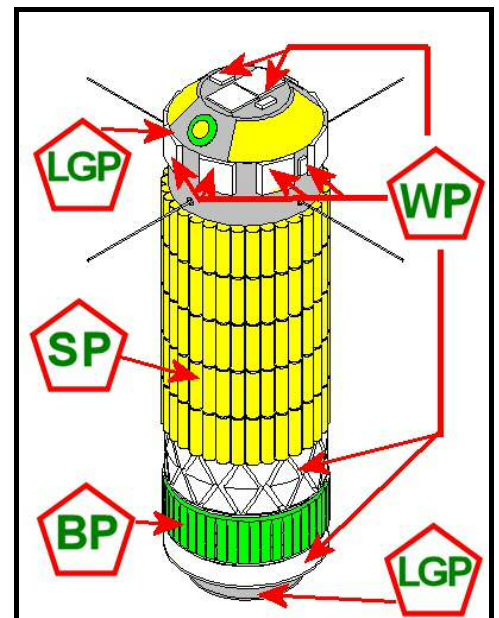

Figure 2

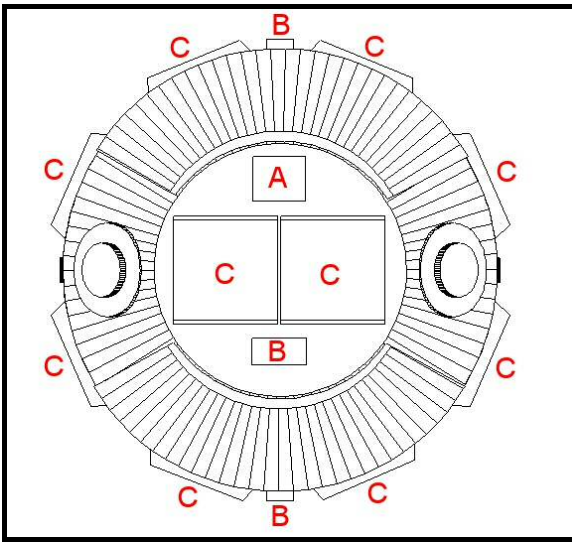

Figure 4

DECAL PLACEMENT

The included Decal Sheet includes one or two extra decals in case you have some troubles with their size. Please find the decals labeled as “A”, in Figure #3, only one is needed, and place it in the location labeled as “A” in Figure# 4. Next find the decal labeled as “B” in Figure# 3, you will need three of them, and place them in the locations labeled

as “B”, in Figure 4. There are two around the circumference of the top and one on the top surface. Finally, find ten decals labeled as “C”, in figure# 3 and place them in the locations shown in Figure# 4. There are eight around the circumference of the top and two on the top.

STEP# 1

Find Parts #1 and #2 and glue together as shown in Figure# 5.

STEP# 2

Take the body assembly from STEP# 1, then find Part# 3 and glue it to the bottom, of the assembly, as shown in Figure# 6

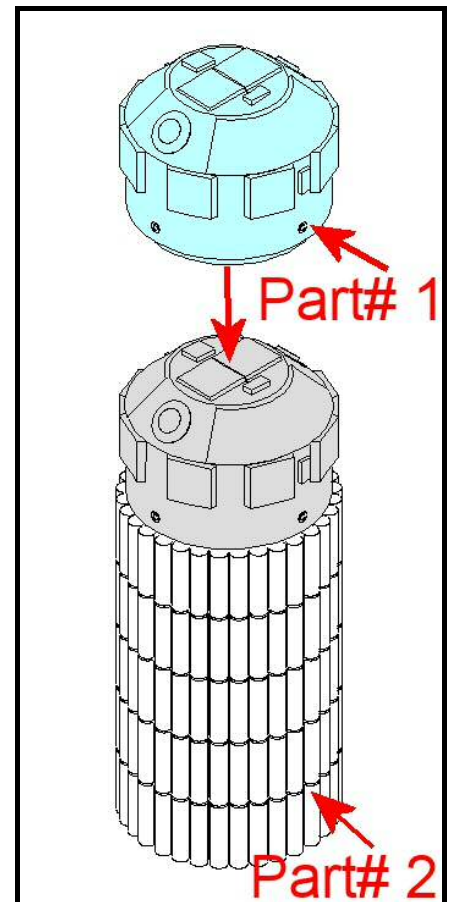

Figure 5

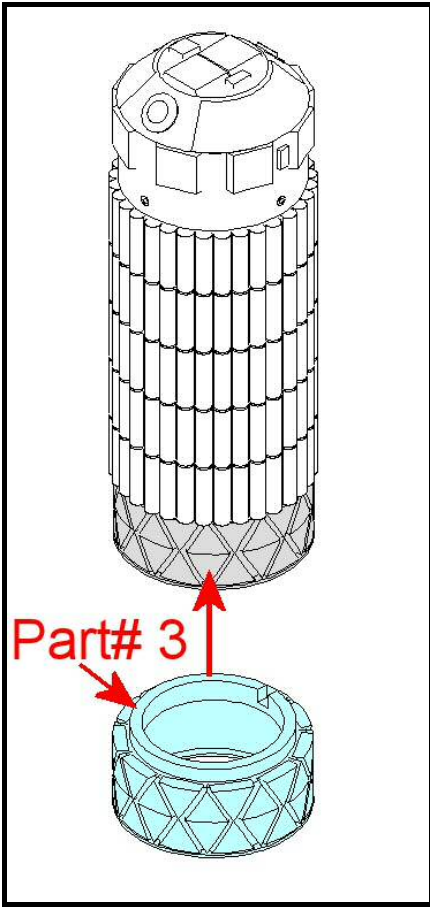

Figure 6

STEP# 3

Now take the body, as assembled in Steps #1, #2 and #3 and glue Part# 4 to the bottom as shown in Figure# 7.

STEP# 4

Your kit includes 7 inches of 0.02 inch music wire. You will need to cut four 1.7 inch pieces to use for the four antenna wires. There are four small, round spots for the antenna to glue into.

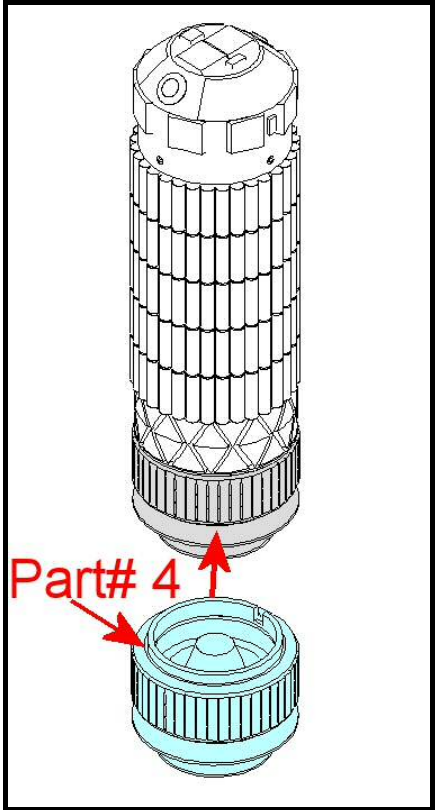

Figure 7

There should be small, 0.022 inch holes in the middle of these spots.

You might have to use a pin vice and a 0.022 inch drill bit to hollow out these four holes. Once this is done, glue the four rods into the holes, as shown in Figure# 8.

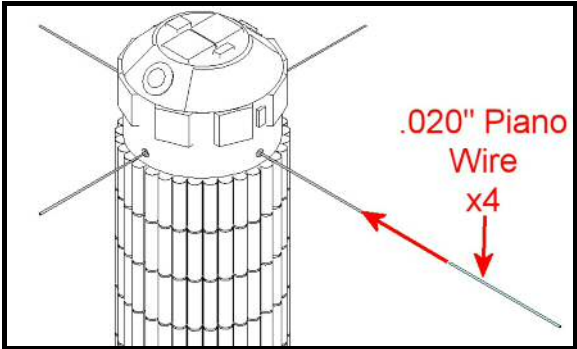

Figure 8

**We hope you enjoy this kit.
Thank You for your purchase.**